



Quick guide





Cleaning agents and cleaning equipment

Aggressive and scouring cleaning agents can damage the surface.
Only use mild, liquid cleaning agents that are kind to the skin.
The Geberit AquaClean cleaning set (art. no. 242.547.00.1) includes a ready-made cleaning agent that is optimal for cleaning all Geberit AquaClean surfaces.



- ⚠ CAUTION**
Damage to the device from aggressive descaling agents
- Only use Geberit AquaClean descaling agent in the device

- i Consumables:**
Geberit AquaClean cleaning set (art. no. 242.547.00.1)
Geberit AquaClean descaling agent (art. no. 147.040.00.1)

Permissible cleaning agents

-  Only use skin-friendly cleaning agents
-  Cleaning agents are permitted to have a low acid content, e.g. heavily diluted citric acid
-  The use of mildly foaming cleaning agents is permitted
-  Only use liquid cleaning agents
-  Water-diluted cleaning agents are preferred

Permissible cleaning equipment

-  Use soft, fine pored sponges
-  Use lintfree, soft towels which are free of dust
-  Use a toilet brush

The device at a glance

- 1 WC lid
- 2 Remote control with magnetic wall-mounted holder
- 3 WC seat
- 4 Lateral control panel
- 5 Dryer arm
- 6 Spray arm

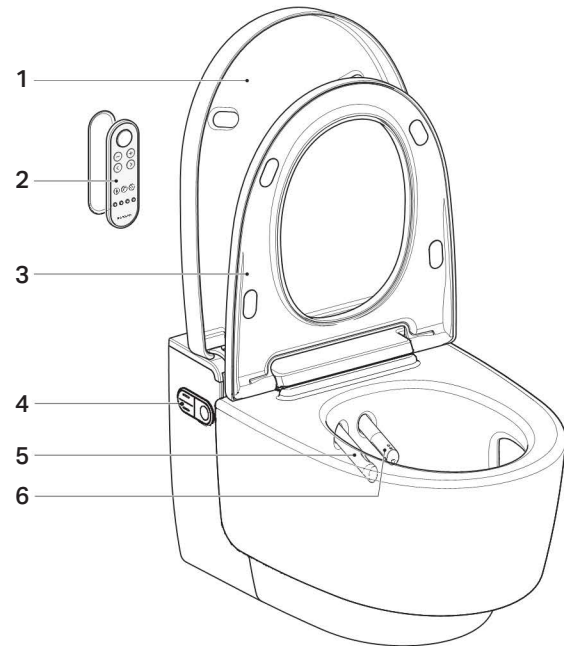

Lateral control panel

The shower toilet functions of the device can be operated from the lateral control panel.

- 1 <up> / <down> buttons: decrease or increase spray intensity
- 2 Status LED
- 3 <Shower> button: start or stop anal shower or Lady shower

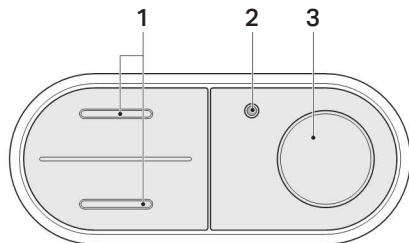

Remote control

All functions for daily use can be operated from the front side of the remote control.

Buttons on the front side

- 1 <Shower> button: start and stop the spray functionality / stop the dryer functionality and Lady shower
- 2 <-> / <+> buttons: decrease or increase spray intensity
- 3 <left> / <right> arrow keys: set the spray arm position
- 4 <Lady shower> button: start and stop the Lady shower
- 5 <Dryer> button: start and stop the dryer
- 6 <Odour extraction> button: start and stop odour extraction
- 7 <User profile> buttons: activate user profile 1-4

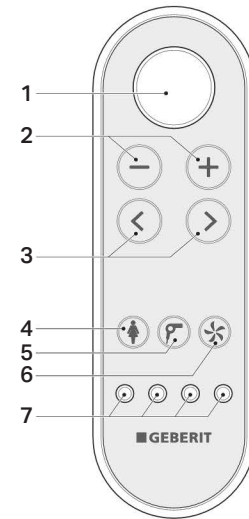

i User profiles allow you to access your personal settings directly. Select your user profile as soon as you sit down.

Buttons on the rear side

- 1 Battery compartment
- 2 Display
- 3 <up>, <down>, <left> and <right> arrow keys

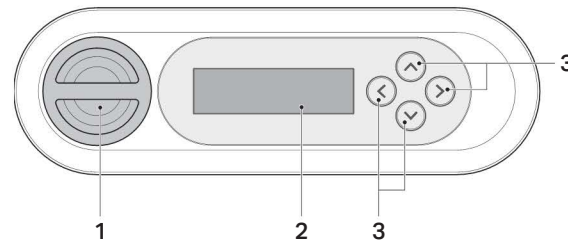

i If the remote control battery is depleted, you can use the lateral control panel instead.

How to use the device

Using the anal shower

Briefly press the <Shower> button on the lateral control panel or on the remote control once.

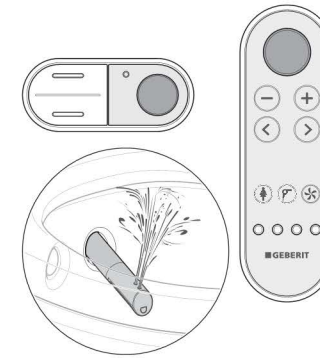

i Press the <Shower> button again to stop the shower procedure early.

Using the Lady shower

Press the <Lady shower> button on the remote control. Or: press the <Shower> button on the lateral control panel for two seconds.



i Press the <Lady shower> button again to stop the shower procedure early.

Adjusting the spray intensity

Press the <up> or <+> button to increase the spray intensity. Press the <down> or <-> button to decrease the spray intensity.



Setting the spray arm position

Press the arrow keys on the remote control to position the spray arm.

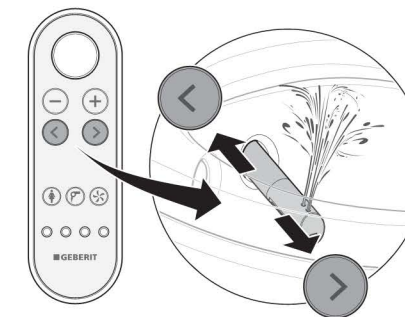

Switching the oscillating motion of the anal shower on and off

The oscillating motion can be switched on and off by pressing the <left> and <right> arrow keys at the same time.

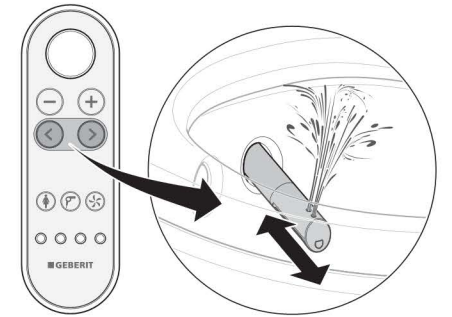

Using the dryer

Press the <Dryer> button on the remote control.

